

AERODROME CHART - ICAO

ARP 555700N 0032221W

AD ELEV 136FT

EDINBURGH EGPH

RUNWAY/TAXIWAY/APRON PHYSICAL CHARACTERISTICS			
APRON / RWY / TWY	SURFACE	BEARING STRENGTH	ELEVATION
RWY 06/24	Grooved Asphalt	87/R/C/W/T	-
RWY 12/30	Grooved Asphalt	31/F/C/X/T	-
North Cargo Apron	Block Paving	31/F/C/X/T	103ft amsl
South Cargo Apron	Concrete	79/R/D/W/T	-
Southeast Apron	Concrete	72/R/C/W/T	-
Main Apron	Concrete	72/R/C/W/T	97ft amsl
Business Aviation Apron	Asphalt/Block P	31/F/C/T	-
Twy A (between A1 and A8 and A17 and D1)	Concrete	120/R/C/W/T	-
Twy A (between A8 and A17)	Asphalt	70/F/A/W/T	-
Twys E, F	Concrete	72/R/C/W/T	-
Twy M	Asphalt	37/F/A/W/T	-
Twys L, Q, U	Asphalt	31/F/C/X/T	-
Twys G, H	Concrete	90/R/D/W/T	-
Twy P	Asphalt	82/R/D/W/T	-
Twy S	Concrete	79/R/D/W/T	-

COM		
ATIS	131.350	EDINBURGH TERMINAL INFO
TWR	118.700	EDINBURGH TOWER
	121.750 (GMC)	EDINBURGH GROUND
	121.600	EDINBURGH FIRE
LIGHTING		
THR 06/24	HI green with HI green W bars.	
THR 12/30	HI green with HI green W bars.	
RWY 06/24	HI bi-d edge. HI colour coded C/L. End lights red. TDZ 914m.	
RWY 12/30	Elev HI bi-d with LI omni-d component. End lights red.	
TWY	Green C/L on 06/24 taxiways. Green C/L on RWY 12/30 to SE apron, North and South Cargo aprons and the Business Aviation Centre. Blue edge for all other taxiways. RWY 06/24 exits have Alt green/yellow lights to CAT II/III stop bars. RWY guard lights on accesses to RWY 06/24.	

GUND (Geoid Undulation) = The height of the Geoid (MSL) above the Reference Ellipsoid (WGS 84) at the stated position.	
BEARINGS ARE MAGNETIC ELEVATIONS AND HEIGHTS ARE IN FEET	
ELEVATIONS IN FEET AMSL	216 (80)
HEIGHTS IN FEET ABOVE AD	(80)

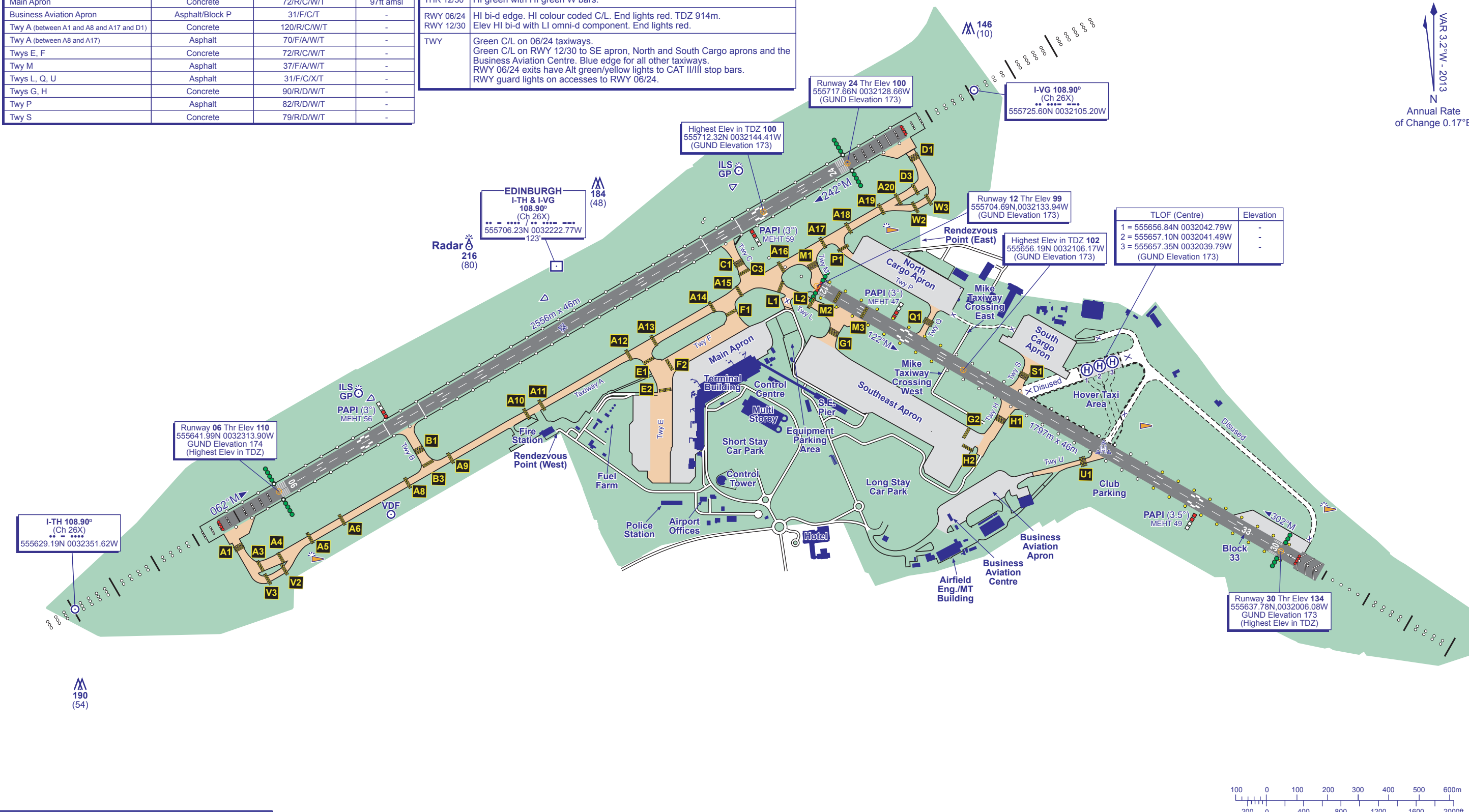

CHANGE (13/13): NEW APRON ABEAM RWY 30 THRESHOLD.