

**AERODROME CHART - ICAO**

ARP 513019N 0000319E

AD ELEV 19FT

**LONDON CITY EGLC**

RUNWAY/TAXIWAY/APRON PHYSICAL CHARACTERISTICS			
APRON / RWY / TWY	SURFACE	BEARING STRENGTH	ELEVATION
RWY 09/27	Grooved Concrete	30/R/C/Y/T	-
Main Apron	Concrete	30/R/C/Y/T	17ft amsl
Main Taxiway	Concrete	30/R/C/Y/T	-

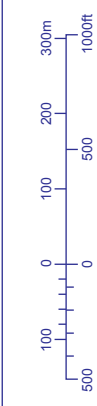

**GUND** (Geoid Undulation) = The height of the Geoid (MSL) above the Reference Ellipsoid (WGS 84) at the stated position.

BEARINGS ARE MAGNETIC ELEVATIONS AND HEIGHTS ARE IN FEET

ELEVATIONS IN FEET AMSL HEIGHTS IN FEET ABOVE AD **308** (289)

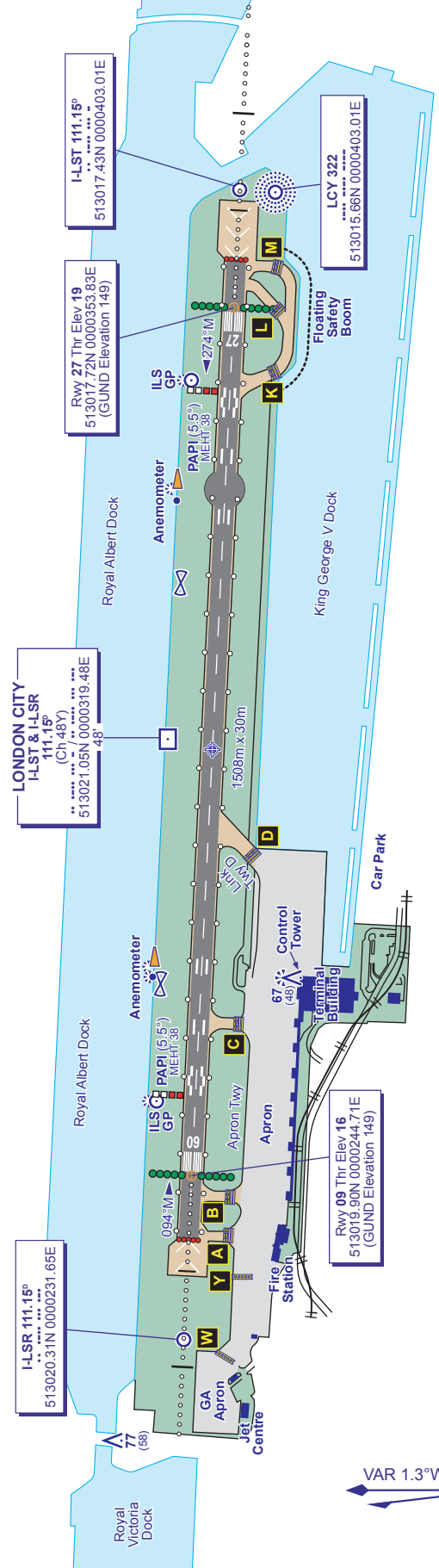

VAR 1.3°W - 2012  
Annual Rate of Change 0.14°E

COM	CITY INFORMATION
ATIS	136.350
TWR	118.075
	121.825 (GMC)
	129.450
	121.600
	(as directed by ATC)
	CITY FIRE
LIGHTING	
APCH 27	462m HI C/L with 2 bars.
APCH 09	401m HI C/L with 2 bars.
THR 27	Flush HI green with HI green W bars.
THR 09	Elev HI green with HI green W bars.
RWY 09	HI bi-d edge. Yellow edge for final 450m. (First 99m red). End lights red.
RWY 27	HI bi-d edge. Yellow edge for final 450m. (First 74m red). End lights red. Blue edge on turning area.
TWY	Green C/L, blue edge on curves. Red stop bars with yellow RWY guard lights at holds.

CHANGE: MAG VAR. RWY 09/27 HEADINGS. COM.